

Shrill[®]

Shaver Drill System

MULTIFUNCTIONAL DRILL AND RESECTION SYSTEM



THE MULTIFUNCTIONAL DRILL AND RESECTION SYSTEM

The joimax® Shrill® system was specially developed for the removal of soft tissue and bone on the spine. It consists of a console, a shaver handpiece and various sterile Shaver Blade attachments. The device functions can be quickly and easily adjusted on the console, on the handpiece or optionally via the foot switch.



THE SHRILL® CONSOLE

- Oscillating clockwise or counterclockwise rotation mode.
- 6 memory settings for the most common applications.
- Glass front with touch display for easy cleaning.

THE SHRILL® HANDPIECES

- Speed regulation directly on the handpiece.
- Quick connection for attachments.
- Autoclavable (134°C / 273°F).

The **Universal Motor Handpiece** is suitable for all procedures in the area of the spine, traumatology and orthopedics. Accessories include a wire driver, drill chuck and a quick-release drill attachment.

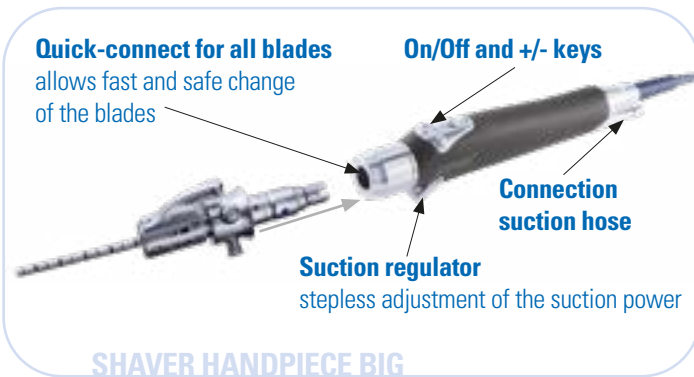
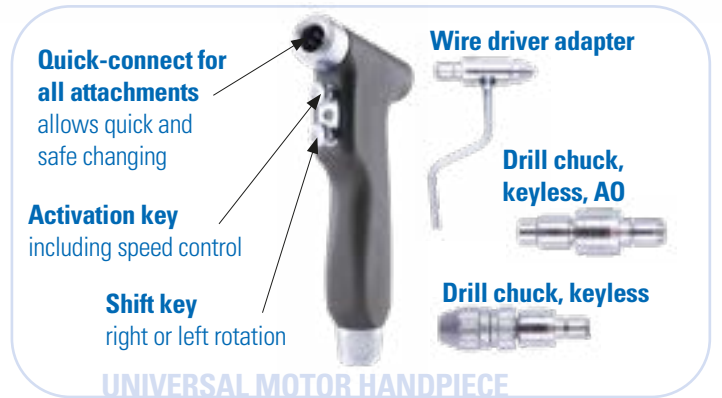

The **Shaver Handpieces** enables the safe and precise use of the Shrill® Shaver Blades for endoscopic spine surgery.

- Moderate speed with high torque for controlled and effective ablation of tissue with continuous flushing.
- Automatic activation of the Shaver Blade by magnetic blade detection.
- Easy control of the suction output.
- Speed up to 10,000 rpm.

For more delicate procedures, such as in the cervical area, a smaller and lighter handpiece is available.

CONTINUOUSLY CLEAR VIEW OF THE SURGICAL FIELD

The patented construction of the joimax® Shrill® Shaver handpiece in combination with the Shaver Blades provides a suction effect depending on the speed and thus ensures a continuously clear view.

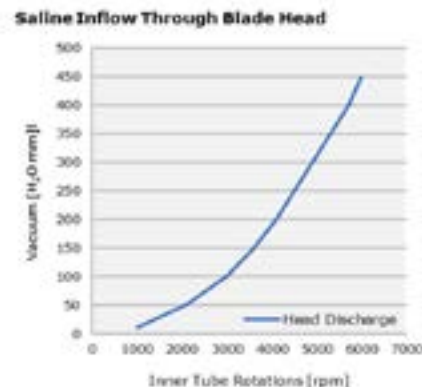
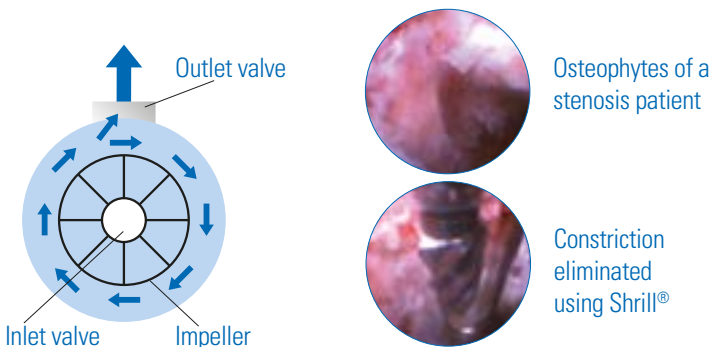

RIGID SHAVER BLADES – SIMPLE HANDLING WITHOUT COMPLEX MECHANICS

The elastic material of the Shaver Blades allows for optimal force transmission. At the same time, the unique design ensures maximum stability.

- Efficient ablation of bone in the case of stenosis and hypertrophic ligamentum flavum.
- Tissue-specific design of the attachments: milling, cutting, abrasing.
- Color-coded attachments for fast and easy identification.
- Depth graduation on the attachments for more safety during use.



Dark yellow | Diamond Abrador

Diamond abrador for safe bone resection near nerves



Red | Barrel Cutter

Abrador for resection of bone, with protection



Purple | Side Cutter

Abrador for resection of bone, with side protection



Blue | Bone Resector

Abrador for resection of bone, without protection

DEFLECTOR SHAVER BLADES – PRECISE BENDING AND A SECURE APPLICATION!

Controlled angulation for the ideal working position.

- Angle can be adjusted safely and conveniently using the lever on the shaft.
- Angle can be adjusted precisely to 12°, 24° or 36°.
- Shaver Blades are securely fixed into place.

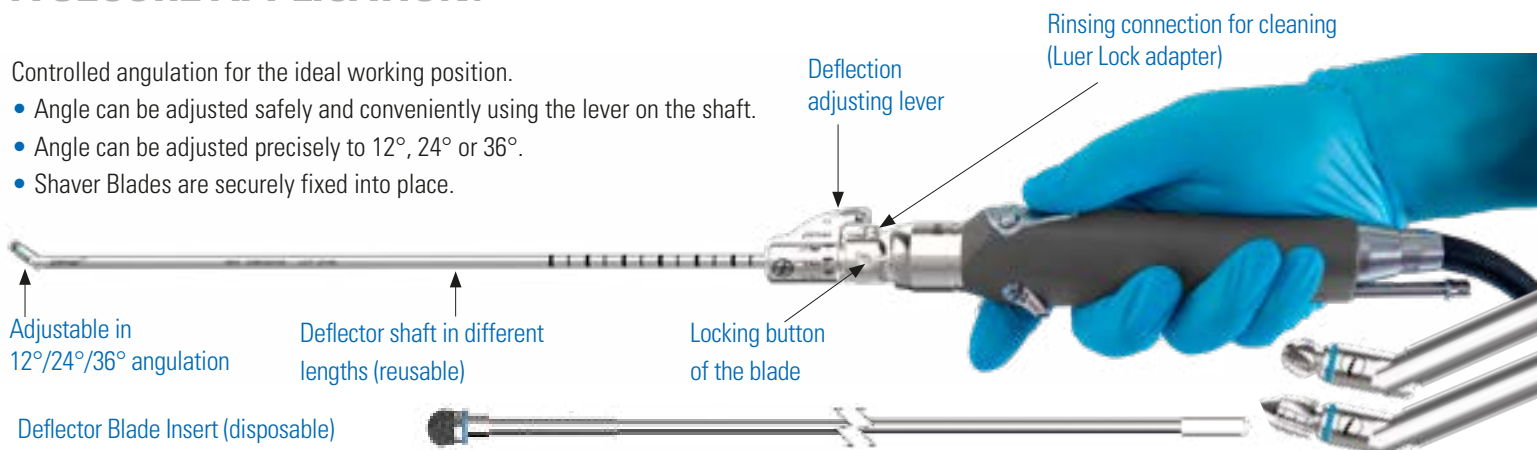

Deflector Blade Insert (disposable)

		SHAVER HANDPIECE		UNIVERSAL MOTOR HANDPIECE	
		BIG	SMALL		
Area of application		Endoscopic spine surgery		Spine surgery, orthopedics, traumatology	
Max. rpm	Rigid Shaver Blades	10,000 (in clockwise/ counterclockwise rotation)	6,000 (in clockwise/ counterclockwise rotation)	–	
	Deflector Shaver Blades	6000 (in clockwise rotation)			
Drill bits and Kirschner wires		–		1,500 (in clockwise/ counterclockwise rotation)	
Activation via button		Yes	No	Yes	
Speed control via button					
Selection buttons (1-2-3) for speed settings					
Magnetic blade detection		Yes	Yes	No	
Quick connection				Yes	Yes
Suction connection					No
Autoclavable				Yes	
Weight [g]		420	220	600	

OVERVIEW OF THE SYSTEM

REF	Description
SHRILL® SETS	
JSHRI02S	joimax® Shrill® System Plus Incl. Console, Shaver Handpiece Plus, Sterilization Tray and Cleaning Adapter (2 pcs.)



SHRILL® HANDPIECES	
JSHRI02SHL	joimax® Shaver Handpiece Big
JSHRI02SHS	joimax® Shaver Handpiece Small
JSHRI020UMH	joimax® Universal Motor Handpiece



SHRILL® ACCESSORIES	
JSHRI02FS	joimax® Shrill® Footswitch
JSDCKL032	joimax® Drill Chuck, Keyless
JSDCA0100	joimax® Drill Chuck, Keyless, AO
JSWDA0618	joimax® Wire Driver Adapter
SHCS305005	joimax® Shaver Handpiece Cleaning Set

ENDOSCOPIC DEVICES

The expert solution for spine surgery and neurosurgery. All devices work in unison with one another and are designed specifically for the treatment of sensitive structures.

1 **Vitegra®**
Visual Integration System

2 **Camsource® LED**
Camera & Light Source System

3 **Intracis® em**
Integrated Navigation Tracking & Control System

4 **Shrill®**
Shaver Drill System

5 **Endovapor® 2**
Multi Radio Frequency System

6 **Versicon®**
Versatile Irrigation Control

7 **JFMS 2620 | 3220 | 314KB**

The image shows one of various mounting options.

For Intracis® em FDA registration is in progress.

joimax® GmbH
Amalienbadstrasse 41, RaumFabrik 61
76227 Karlsruhe, Germany

Phone +49 (0) 721 255 14-0
Fax +49 (0) 721 255 14-920
E-Mail info@joimax.com
Net www.joimax.com

joimax®, Inc.
140 Technology Drive, Suite 150
Irvine, CA 92618, USA

Phone +1 949 859 3472
Fax +1 949 859 3473
E-Mail info@joimaxusa.com
Net www.joimax.com

joimax® Asia
Rykadan Capital Tower,
135 Hoi Bun Road,
Kwun Tong, Hong Kong

Phone +852 29116418
E-Mail asia@joimax.com
Net www.joimax.com

joined minimal access

joimax® BROSHRIEN; TD_SHRI_15_PI_005, Rev. 008, Oct. 2020